

剖面 A-A

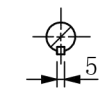

键: 5*5*30

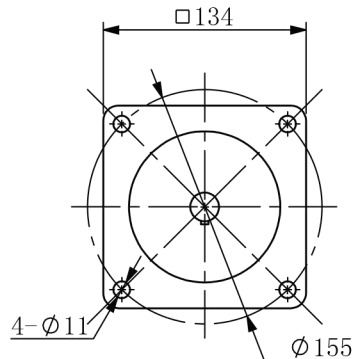
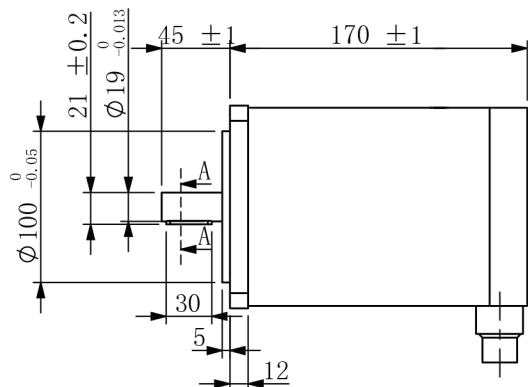

接线图/WIRING DIAGRAM

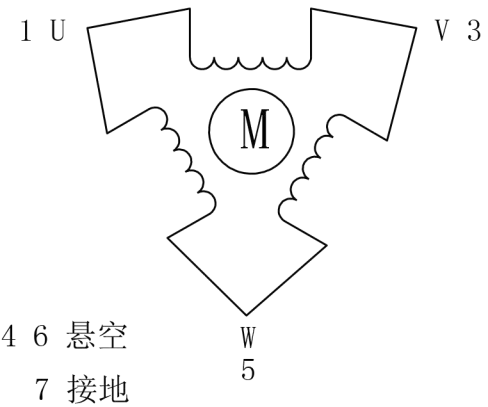

电机特性参数/ELECTRICAL PARAMETER

步距角/STEP ANGLE	1.2° ±5%
相数/NO. OF PHASES	3
额定电压/RATED VOLTAGE	6.5V
额定电流/RATED CURRENT	5.0A
电阻/RESISTANCE	0.95ohm ±10% AT25°C
电感/INDUCTANCE	9.5mH ±20% AT 1kHz, 1Vrms
保持力矩/HOLDING TORQUE	23N.m
运行力矩/(AT —PPS) RUNNING TORQUE(AT —PPS)	——以上/MIN (——V.DC, ——A/相(PHASE), ——相励磁/EX)
绝缘耐压/DIELECTRIC STRENGTH	500V A.C 1分钟/MINUTE
绝缘电阻/INSULATION RESISTANCE	100MΩ 以上/MIN.
绝缘等级/INSULATION CLASS	CLASS B
温度上升/TEMPERATURE RISE	80K MAX.
转子惯量/ROTOR INERTIA	35kg.cm ²
重量/WEIGHT	约/APPROX. 18.4千克/kg
允许轴向负载/ALLOWABLE THRUST LOAD	20N
允许径向负载/ALLOWABLE RADIAL LOAD	200N(轴端/ON THE SHAFT END)
运行环境温度/OPERATION AMBIENT TEMP.	-20°C——+50°C
运行环境湿度/OPERATION AMBIENT HUM.	15%——90%
寿命/LIFE	5000小时/HOURS

备注(NOTE):
 1. 额定电流, 两相同时通电/AT RATED CURRENT, TWO PHASES ON.
 2. 热阻法: 电机安装在84*84*T5的铝板上, 电机线圈两端通额定电压, 0PPS /MEASURED BY RESISTANCE METHOD. MOUNT WITH ALUMINUM HEAT SINK 84*84*T5 AT TWO WINDING BE EXCITED BY RATED VOLTAGE, 0PPS, 2PHASE ON.
 3. 寿命测试条件: 整步, 运行速度为500PPS, 轴承的表面温度不超过70°C
 LIFE TEST CONDITION: 2PHASE EXCITING, FULL STEP, AT 500PPS. STARTING PULSE, BEARING TEMPERATURE SHOULD BE 70°C MAX.

已受控

CONFIRMED&ACCEPTED BY CUTOMER (客户确认&接受)										
COMPANY CHOP&SIGNATURE (盖章&签名)										
一般公差 TOLERANCE	±0.3/±3°	版本 REV.	年月日 DATE	变更番号 ECR NO.	变更内容 REVISIONS	设计 BY	备注 NOTE	REV.	A	
设计/DESIGNED		比例 SCALE		型号/MODEL						三维图 THIRD ANGLE PROJECTION
审核/CHECKED		单位 UNIT	mm	130B23						
深圳锐特机电技术有限公司								页 SHEET	1/1	